

# MBPCX 50 T4 2,2kW Zone 2: FAN (Ex h IIB T4 Gc) + MOTOR (Ex db IIC T4 Gb) (502305054XD)

## GENERAL DATA



PLASTIC ATEX FAN WITH FORWARD IMPELLER

### MANUFACTURING FEATURES

- Housing made of PP-el plastic (for models size 35 and equal to or greater than size 45) other models PE-el casing
- Forward curved impeller in PP plastic.
- Motor support made of rolled steel sheet with polyester powder finishing coat.
- Stainless steel nuts and bolts.
- Standard asynchronous squirrel-cage motor, IP-55, class F insulation. Standard voltages 230/400V 50Hz for three phase motors up to 4kW and 400/690V 50Hz for higher powers. Equipped with ATEX motors

- Available positions (to be indicated in case of order): LG270, LG0, LG45, LG90, LG135, LG180, LG225, LG315, RD0, RD45, RD90, RD135, RD180, RD225, RD270, RD315.
- The indicated codes correspond to the model in position LG270

### APPLICATIONS

Designed for inline installation, they are suitable for:

- Corrosive air transport.
- Chemical and petrochemical industry.
- Laboratories and gas cabinets.
- General ventilation in closed environments classified as ATEX zone 2.
- Maximum temperature of transported air: If it is clean air 70°C, other depends on the gas (see table in documentation)

### UNDER REQUEST

- 60Hz fans and special voltages fans.
- Stainless steel motor support.

In compliance with the ATEX Directive 2014/34/UE. Certified ATEX IIIG with certified ATEX motor for areas 2 (gas)

## PERFORMANCE CURVE

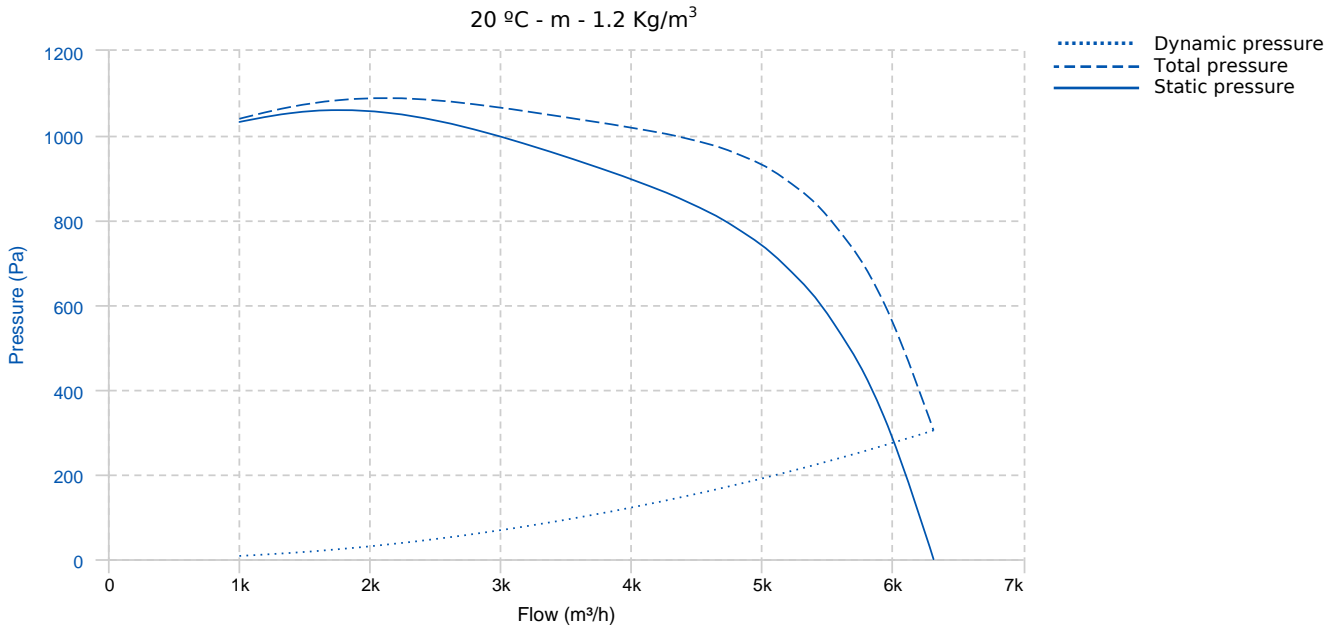

## TECHNICAL DATA

Fan							
RPM	1440	Approx. weight	77 kg	Max. Flow	6310 m³/h		
Motor							
Power	2,2 kW	RPM	1440	I max. (400V)	5,8 A	Size	100L
Approx. weight	20 kg	Efficiency (%)	80 %	FP	0.77		

## DIMENSIONS

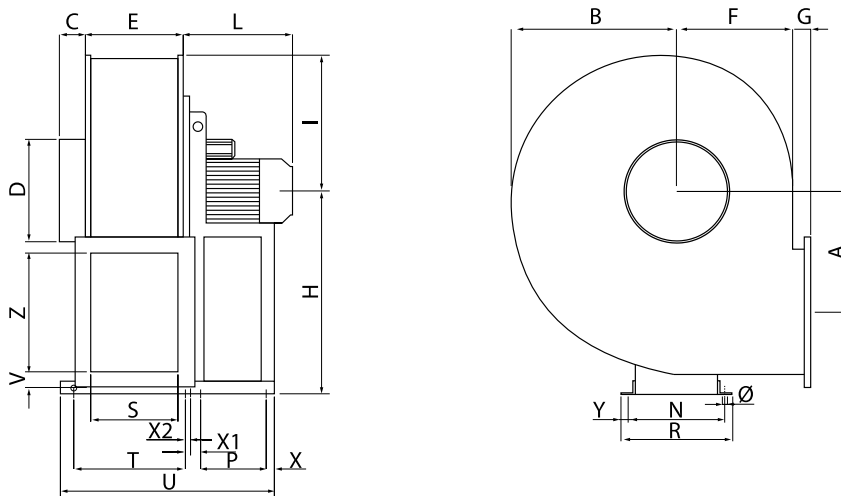

Dimensions (mm)									
A	377	B	390	C	80	D	315	E	280
F	450	G	50	H	630	I	395	L	300

## Dimensions (mm)

N	289	P	237	R	325	S	260	T	390
U	730	V	50	X	25	X1	28	X2	25
Y	18	Z	365	Ø	14				

## WIRING DIAGRAM

230V 

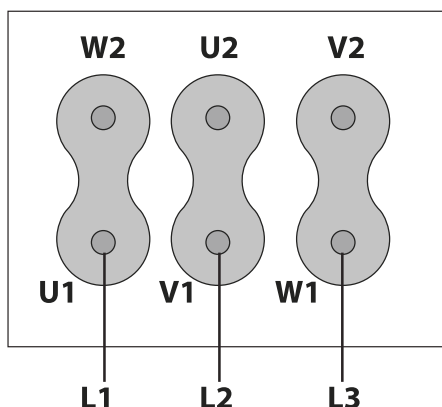

400V 

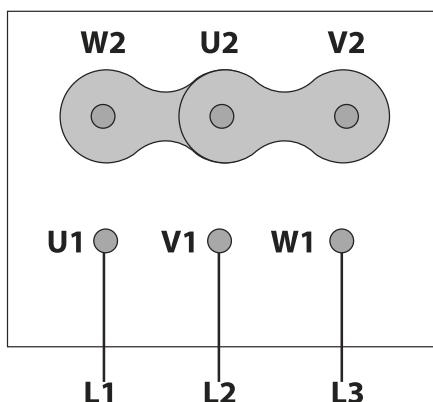

## ACCESSORIES



**ANTI-VIBRATING FLANGE 400<sup>º</sup>/2H**  
BA-400 30/31  
REF: 960002052



**ANTI-VIBRATION JOINT**  
JE 45  
REF: A-300719201



**ATEX SWITCH**  
INT 16 ATEX  
REF: 510200016X



**PVC FLEXIBLE JOINT**  
FJ Ø315  
REF: FJ-315



**DIFUSOR GRID**  
DG Ø315  
REF: DG315



**CIRCULAR GRAVITY DAMPER**  
CSC Ø315  
REF: CSC315



**ADJUSTABLE DAMPER**  
AD Ø315  
REF: AD-315



**DRAIN PLUG**  
PD 2  
REF: PD2

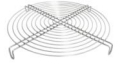

**STAINLESS STEEL PROTECTION GRID**  
RPI Ø315  
REF: RPI315



**WALL SUPPORT**  
WS 1  
REF: WS1



**ANTI-VIBRATION BLOCK**  
AV 3  
REF: AV-3



**FREQUENCY SPEED CONTROLLER**  
SFC 400 III 8A \*  
REF: SFC400III8



**ANTI-VIBRATION RUBBER BLOCK**  
AVR (GENERIC)



**ANTI-VIBRATION SPRING BLOCK**  
AVS (GENERIC)

## SPARE PARTS

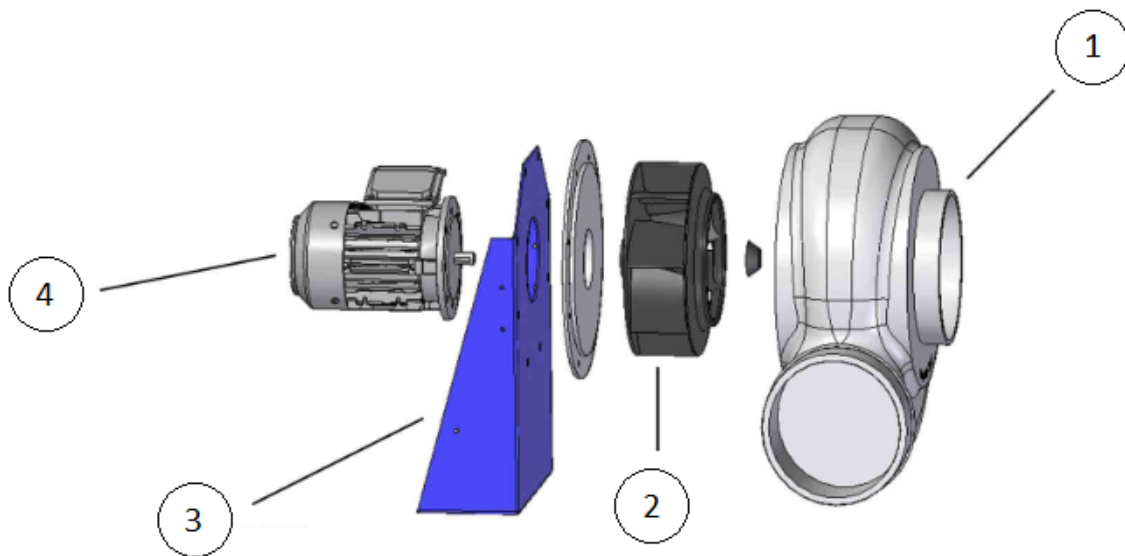

	Code	Model	Qty
1	T03105054	IMPELLER MBPCX 50 T4 2,2 kW LG	x1
2	721601160	MOTOR 2,2KW 1500 B5 230/400V II2G IIC T4 Ex-d Gb IP66	x1